



# XMG, XTG, XSG

-24, 36, 48, 60, 72  
Gas Counter Top Griddles



30 Pine Street • New Rochelle • New York • 10801  
 1 - 914 / 576 - 0200  
 1 - 914 / 576 - 0605 fax  
 1 - 800 - 431 - 2745 US & Canada  
 www.bakerspride.com web address

## Model XSG-24,36,48,60 & 72

### EXPLODED VIEW

*Cookline*  
SERIES

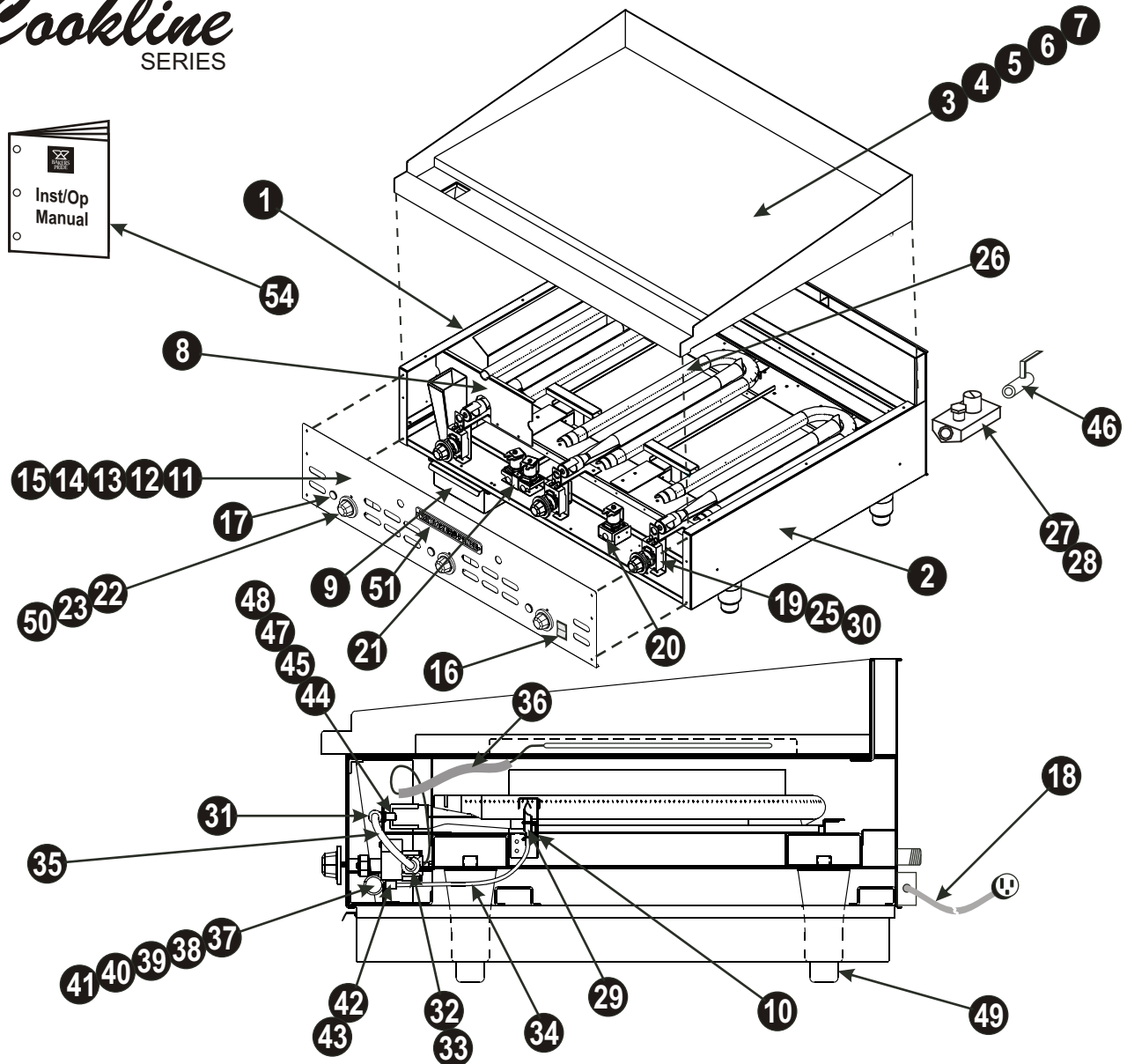

#### Additional Hardware Not Shown

P/N	Description	P/N	Description	P/N	Description
N3068P	Pressure Tap Nozzle	Q1407A	Screw, #10 x 1/2", Hex Hd, Slot	Q2038A	Weld Screw, 1/4-20 x 5/8"
P1035A	Wire Nut	Q1412A	Screw, #10 24 x 3/8", Truss Hd, Slot	Q2046A	Nut, 1/4-20, Hex, Lock
Q1001A	Screw, 6-32 x 1/4", Rnd Hd, Slot	Q1472A	Screw, 1/4-20 x 1/4", Button Hd	Q2055A	Screw, 1/4-20 x 2-1/4, Flat Hd, Slot
Q1401A	Screw, 10-32 x 1/2", Pan Hd, Slot	Q2002A	Screw, 1/4-20 x 1/2", Truss Hd, Slot	Q2335A	Nut, 3/4-10, Hex, Heavy
Q1406A	Screw, #10 x 1/2", Truss Hd, Slot	Q2027A	Screw, 1/4-20 x 1/2", Hex Hd	Q3044A	Washer, Thk, Flat

Model Number - Width			Serial Number	Type of Gas	Voltage, Amps
XMG <input type="checkbox"/>	-24" <input type="checkbox"/>	-60" <input type="checkbox"/>	_____	Natural <input type="checkbox"/>	120 Volts, 1 Amp (Model XSG Only)
XTG <input type="checkbox"/>	-36" <input type="checkbox"/>	-72" <input type="checkbox"/>		L.P. <input type="checkbox"/>	
XSG <input type="checkbox"/>	-48" <input type="checkbox"/>			Other <input type="checkbox"/>	

Item	XTG	XMG	XSG	Description
	Part Number			
1	G7002K	G7002K	G7002K	Outer Side, Left
2	G7003K	G7003K	G7003K	Outer Side, Right
3	G8001U	G8106U	G8106U	Griddle Plate Assy 24"
4	G8002U	G8102U	G8102U	Griddle Plate Assy 36"
5	G8003U	G8103U	G8103U	Griddle Plate Assy 48"
6	G8004U	G8104U	G8104U	Griddle Plate Assy 60"
7	G8005U	G8105U	G8105U	Griddle Plate Assy 72"
8	G8057K	G8057K	G8057K	Heat Shield, Front
9	G8061K	G8061K	G8061K	Grease Drawer
10	G8062U	G8062U	G8062U	Pilot Bracket Assembly
11	G8077U	G8097K	G8017U	Control Panel Assy, 24"
12	G8093U	G8076K	G8018U	Control Panel Assy, 36"
13	G8094U	G8098K	G8019U	Control Panel Assy, 48"
14	G8095U	G8099K	G8020U	Control Panel Assy, 60"
15	G8096U	G8100K	G8021U	Control Panel Assy, 72"
16	-----	-----	M1307A	Switch, Rocker
17	-----	-----	P1168A	Indicator Light, Red
18	-----	-----	P6004A	Power Cord
19	-----	R3032A	-----	Valve, Lml-15
20	-----	-----	R3200A	Solenoid Valve, Single
21	-----	-----	R3201A	Solenoid Valve, Dual
22	-----	S1416A	-----	Knob, Gas Valve On-Off
23	-----	-----	S1419A	Knob 450°F, KX Thermostat
24	-----	-----	U1363A	Label, Wiring Diagram (Not Shown)
25	-----	-----	M1461A	KX Thermostat, 450°F (w/Knob & Sleeve)
26	L5104A	L5104A	L5104A	Burner, Horse Shoe
27	M1009A	M1009A	M1009A	Pressure Regulator, 3/4", 10" WC, LP
28	M1184A	M1184A	M1184A	Pressure Regulator, 3/4", 3.5" WC
29	M1463A	M1463A	M1463A	Pilot Burner
30	M1465A	-----	-----	BJ Thermostat, 450°F (w/Knob & Sleeve)
31	N3083A	N3083A	N3083A	Brass Orifice Fitting, Elbow 3/8"
32	N3084A	N3084A	N3084A	Elbow 3/8", Brass, Compression
33	N3089A	N3089A	N3089A	Brass Fitting, Compression 3/8"
34	N5854A	N5854A	N5854A	Aluminum Tubing 3/16"
35	N5856A	N5856A	N5856A	Aluminum Tubing 3/8"
36	P1029A	P1029A	P1029A	Sleeve, 1/4" Thermo-Flex Insulation
37	R1153A	R1153A	R1142A	Manifold 24"
38	R1154A	R1154A	R1143A	Manifold 36"
39	R1155A	R1155A	R1144A	Manifold 48"
40	R1156A	R1156A	R1145A	Manifold 60"
41	R1157A	R1157A	R1146A	Manifold 72"
42	R3020A	R3020A	R3020A	Valve, Pilot Double
43	R3021A	R3021A	R3021A	Valve, Pilot Single
44	R3023A	R3023A	R3023A	Orifice, Blank
45	R3205A	R3205A	R3205A	Orifice #38, Nat Gas
46	R3206A	R3206A	R3206A	Valve, Gas Shut-off
47	R3222P	R3222P	R3222P	Orifice #52, LP Gas
48	R3250P	R3250P	R3250P	Orifice #53, But/Prop Gas
49	S1395A	S1395A	S1395A	Leg 6", Adjustable
50	S1420A	-----	-----	Knob 450°F, BJ Thermostat
51	U1044A	U1044A	U1044A	BP Logo 8" Nameplate
52	U1362A	U1362A	U1362A	Label, Lighting Instruction (Not Shown)
53	U1364A	U1364A	U1364A	Label, Warning (Not Shown)
54	U4179A	U4179A	U4179A	Installation/Operation Manual